

SERIE 1200 Flexi millerighe ammortizzato

SERIES 1200 Flexi milled with soft closing

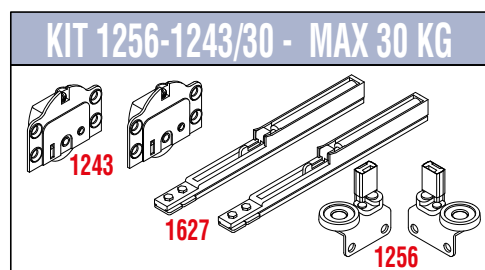

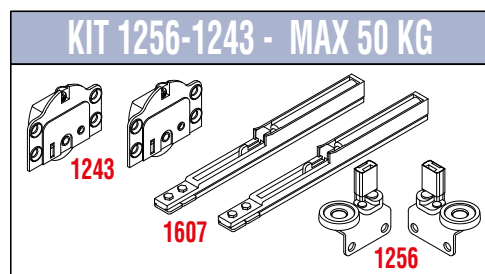



Sistemi scorrevoli per armadi / sliding systems for wardrobes

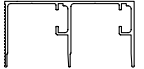

Legenda KIT / Kit Legend

1256	Guida superiore DX-SX <i>Upper runner left-right</i>
1243	Carrello inferiore regolabile con cuscinetto <i>Lower adjustable truck with ball bearing</i>
1607	Fermo superiore ammortizzato fino a 60 kg <i>Soft closing upper stopper up to 60 kg</i>
1627	Fermo superiore ammortizzato fino a 30 kg <i>Soft closing upper stopper up to 30 kg</i>

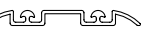
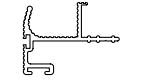
Legenda altri componenti Legend other items

1253 TN		Profilo alluminio superiore <i>Upper aluminium profile</i>
1215		Profilo alluminio inferiore <i>Lower aluminium profile</i>
1260		Profilo alluminio inferiore <i>Lower aluminium profile</i>
1222		Profilo maniglia alluminio (per spessore 22mm) <i>Aluminium handle profile (for thickness 22mm)</i>
1221		Guarnizione plastica (per ART.1222 e ART.1224) <i>Plastic profile (for ART.1222 and ART.1224)</i>

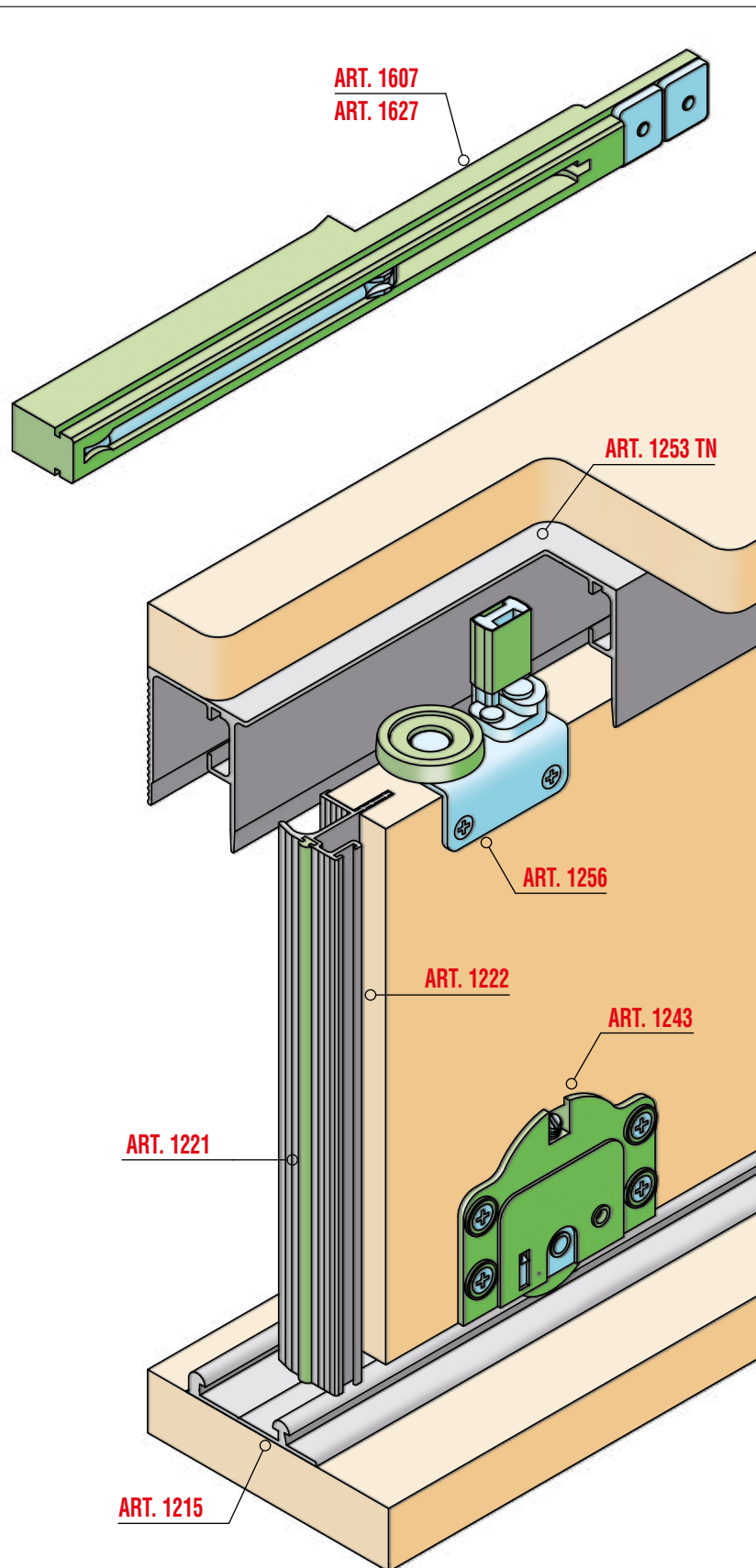



Sistemi scorrevoli per armadi / sliding systems for wardrobes

Sezione verticale / Vertical section

Peso massimo anta Kg. 60
Maximum door weight Kg 60

$H = X - 51,5$

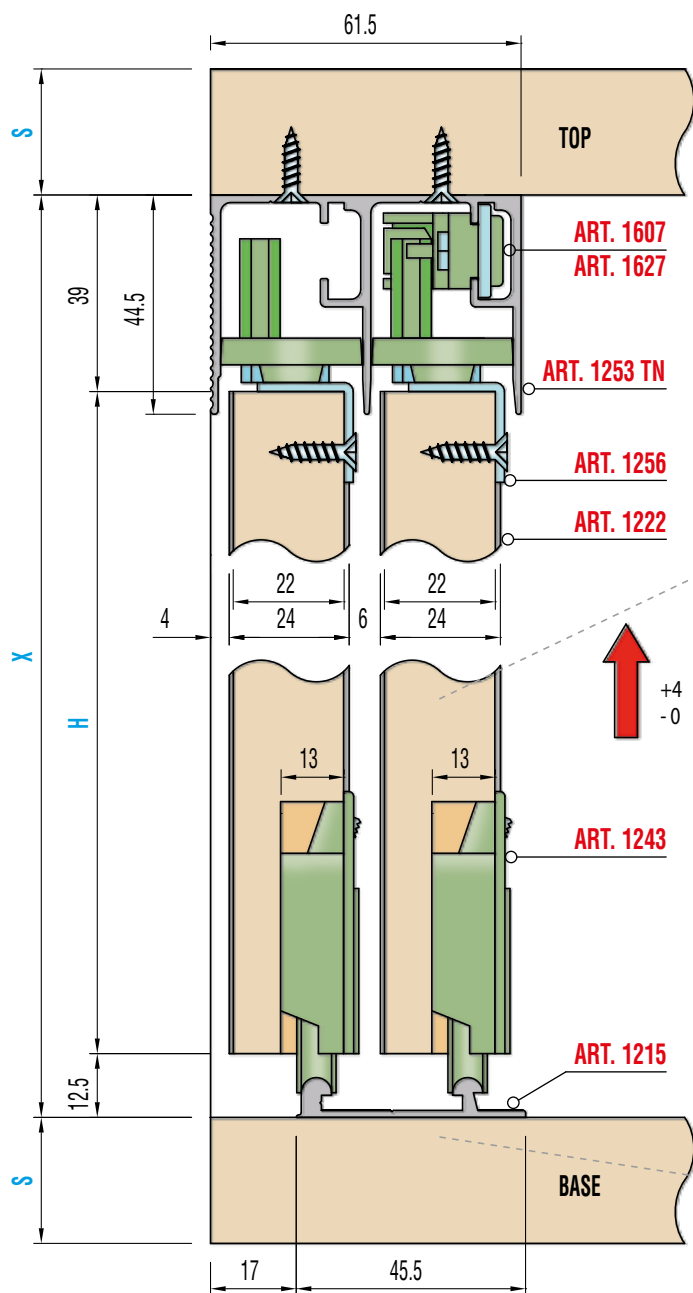

Variante Special version

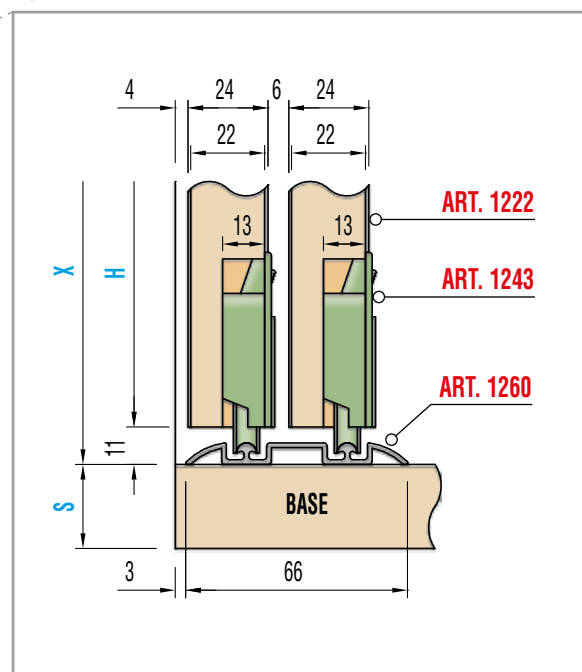

$H = X - 50$

Schema Foratura ante / Doors drilling

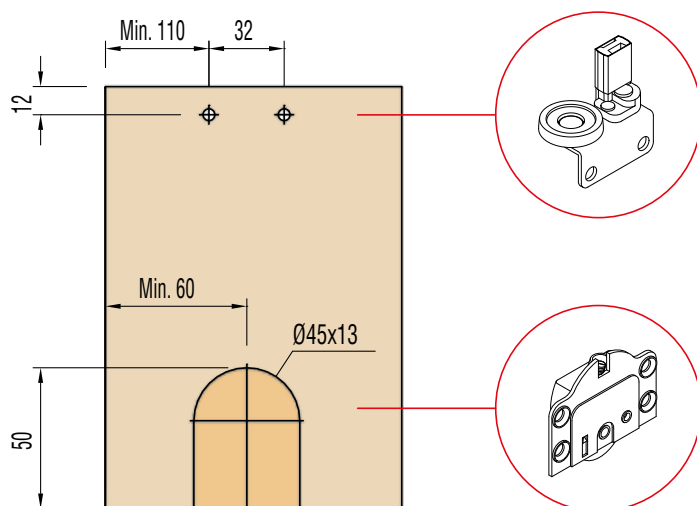



Sistemi scorrevoli per armadi / sliding systems for wardrobes

Schema foratura profili maniglia / Drilling handle profile

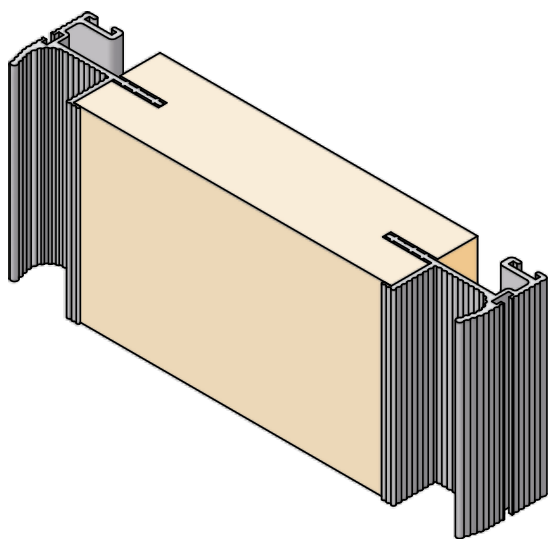

PROFILO MANIGLIA ART.1222 - HANDLE PROFILE ART.1222

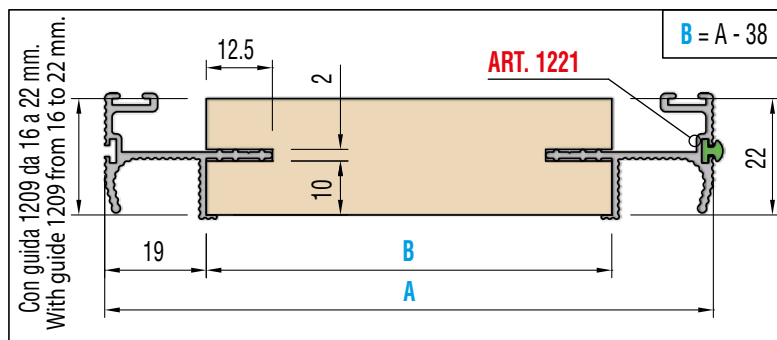

PROFILO MANIGLIA ART.1220 - HANDLE PROFILE ART.1220

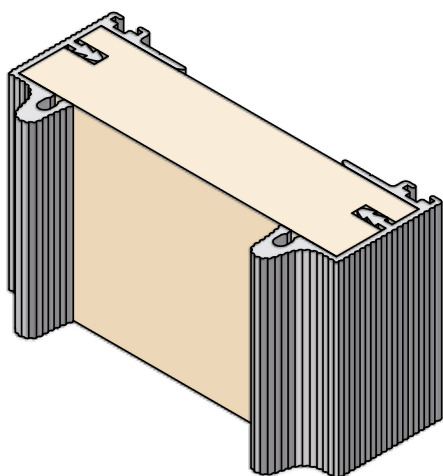
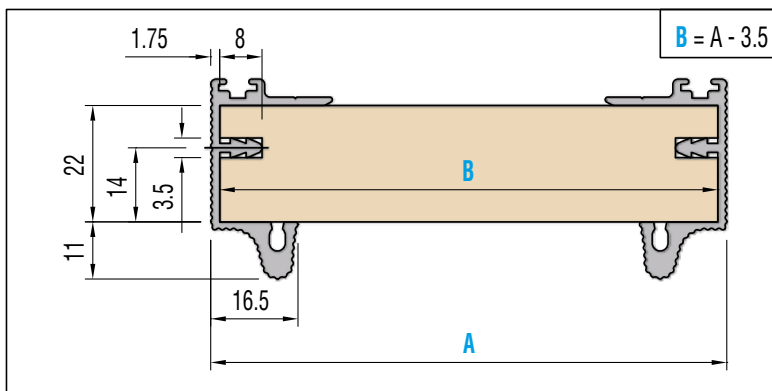

PROFILO MANIGLIA ART.1220 - HANDLE PROFILE ART.1220

